



**GANPATI INFRASTRUCTURE
DEVELOPMENT COMPANY LTD. (GIDCO)**

Corp. Office: Ganpati square 94,
Vijay Nagar Colony, Agra 282004

Site Address - Pocket F, Vibuti Khand,
Gomti Nagar, Lucknow

Email:- info@ganpaticapitalcourt.co
Web:- www.ganpaticapitalcourt.co

Business Suites
Designed for business brilliance.

The Rise of Emerging Service Suites





Capital Court is a world-class complex, strategically situated in the heart of Vibhuti Khand, Gomti Nagar, Lucknow, offering unparalleled proximity to high-class residential neighborhoods as well as premium retail and office spaces. This prime location fosters a sophisticated environment, making it an ideal choice for businesses, professionals, and entrepreneurs seeking a perfect blend of luxury, convenience, and functionality.

The complex is well-connected to key areas of the city, ensuring seamless access for both residents and businesses. Its central position makes it an ideal hub for high-profile ventures and thriving enterprises. Designed with the needs of modern businesses in mind, **Capital Court** offers an upscale, dynamic atmosphere that encourages collaboration, growth, and success.

Whether for work, meetings or leisure, the surrounding environment complements the complex's world-class amenities, creating a perfect balance of productivity and relaxation. With its top-tier business infrastructure, elegant living spaces, and excellent accessibility, **Capital Court** is the premium choice for those seeking to succeed in an urban, high-end setting.



Business Suites offer a seamless blend of work and living spaces, designed for entrepreneurs, professionals, and business owners who seek to work and reside within the same environment. This innovative concept enhances productivity, convenience, and leisure, by integrating high-end office facilities with meticulously crafted residential units, all complemented by a world-class clubhouse.

This combination allows for a balanced, efficient lifestyle, eliminating the need for commuting between separate locations. With workspaces and relaxation zones just steps away, professionals can focus on their business goals while enjoying the comfort and luxury of their living spaces. Whether it's for meetings, work, or unwinding, the design fosters a dynamic, productive lifestyle, effortlessly blending business and leisure in one harmonious setting.





1 ECO- FRIENDLY
TERRAIN



2 SMART
NEIGHBOURHOOD



3 EASY ACCESS
TO AIRPORT



4 METRO
CONNECTIVITY



5 SMOOTH ROAD
CONNECTIVITY

Surrounded
By Thriving
Commercial
Atmosphere of

Business Suites
Designed for business brilliance.

Nestled amidst a vibrant ecosystem of premium business suites, Ganpati Capital Court stands as the new landmark of commercial success in Lucknow. Designed for ambitious professionals and forward-thinking brands, it thrives at the heart of a dynamic commercial corridor - where every square foot is infused with purpose, potential, and progress.



Business  Suites
Designed for business brilliance.

Entrance Lobby





Business Suites Entry Plaza



Business Suites - Live & Work Concept View



Email:- info@ganpaticapitalcourt.co | Web:- www.ganpaticapitalcourt.co



Business Suites Work & Work Concept View



Business Suites
Designed for business brilliance.

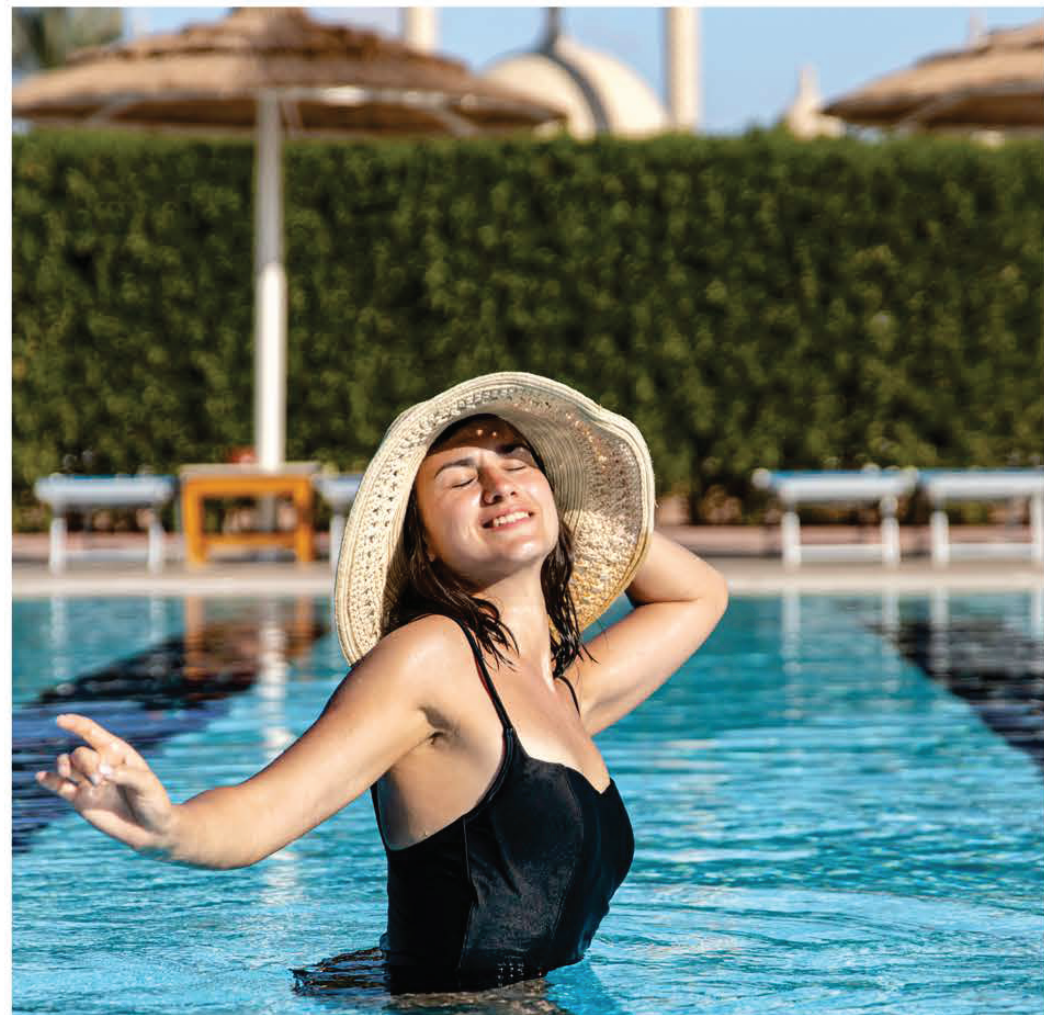

Amenities chart for 3rd floor

Crafted for the modern professional, our Business Suites in Lucknow offer more than just a workspace - they deliver a thriving environment built for success. From high-speed connectivity and smart infrastructure to concierge services and collaborative zones, every detail is tailored to elevate your workday. With premium amenities and a future-ready design, it's not just a place to work - it's where businesses grow, connect, and lead.

SPECIFICATIONS

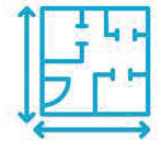

EXTERNAL Lobby

| | | |
|---------------------------------|---|---|
| Flooring | : | Italian Marble |
| Walls | : | Velvet Touch Acrylic Emulsion/Textured wallpaper & Wood & fabric panelling for visual interest. Accent walls for added elegance |
| Ceiling | : | False ceiling with Acrylic Emulsion |
| Doors | : | Glazed door as/façade |
| Windows | : | NA |
| Fixtures/Fittings/Others | : | - |



Passenger Lift Lobby

| | | |
|---------------------------------|---|--|
| Flooring | : | Italian Marble |
| Walls | : | Acrylic Emulsion + Full height Italian on Lift Facia |
| Ceiling | : | False ceiling with Acrylic Emulsion |
| Doors | : | - |
| Windows | : | NA |
| Fixtures/Fittings/Others | : | - |



Service Lift Lobby

| | | |
|-----------------|---|--|
| Flooring | : | Granite |
| Walls | : | Acrylic Emulsion + Full height Italian on Lift Facia |
| Ceiling | : | Gypsum Board False Ceiling |
| Doors | : | Metal Fire Door with SS hardware |
| Windows | : | NA |

Fixtures/Fittings/Others : -



STAIRCASE

| | | |
|---------------------------------|---|--|
| Flooring | : | Kota Stone/ Granite |
| Walls | : | Enamil Paint |
| Ceiling | : | Plastic Paint |
| Doors | : | Metal Fire Door with SS hardware |
| Windows | : | Anodized aluminum pressurization grill |
| Fixtures/Fittings/Others | : | - |



PANTRY

| | | |
|---------------------------------|---|-------------------------------------|
| Flooring | : | Tile |
| Walls | : | Tile above counter & behind cabinet |
| Ceiling | : | Gypsum Board False |
| Doors | : | Wooden Flush door |
| Windows | : | NA |
| Fixtures/Fittings/Others | : | - |

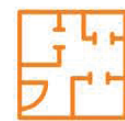

MEETING ROOM

| | | |
|---------------------------------|---|----------------------------|
| Flooring | : | Carpet Flooring |
| Walls | : | Acrylic Emulsion |
| Ceiling | : | Gypsum Board False Ceiling |
| Doors | : | Frameless Glazed Door |
| Windows | : | NA |
| Fixtures/Fittings/Others | : | - |



VESTIBULE

| | | |
|---------------------------------|---|-------------------------------------|
| Flooring | : | Granite |
| Walls | : | Acrylic Emulsion |
| Ceiling | : | False ceiling with Acrylic Emulsion |
| Doors | : | Wooden Flush door |
| Windows | : | NA |
| Fixtures/Fittings/Others | : | - |



ROOM

| | | |
|---------------------------------|---|---|
| Flooring | : | Wooden Laminate Flooring |
| Walls | : | Acrylic Emulsion |
| Ceiling | : | False ceiling with gypsum |
| Doors | : | NA |
| Windows | : | Powder Coated Aluminium Sleek System with Toughened Glass |
| Fixtures/Fittings/Others | : | - |



TOILET

| | | |
|---------------------------------|---|-------------------------------|
| Flooring | : | Granite |
| Walls | : | Tiles |
| Ceiling | : | Gypsum Board False Ceiling |
| Doors | : | Wooden Flush door |
| Windows | : | NA |
| Fixtures/Fittings/Others | : | Granite Counter with Fixtures |

Business Suites
Designed for business brilliance.

Sky View of Building



Email:- info@ganpaticapitalcourt.co | Web:- www.ganpaticapitalcourt.co

Saleable Area - 686 Sqft

Layout Plan Service Apartment Floor

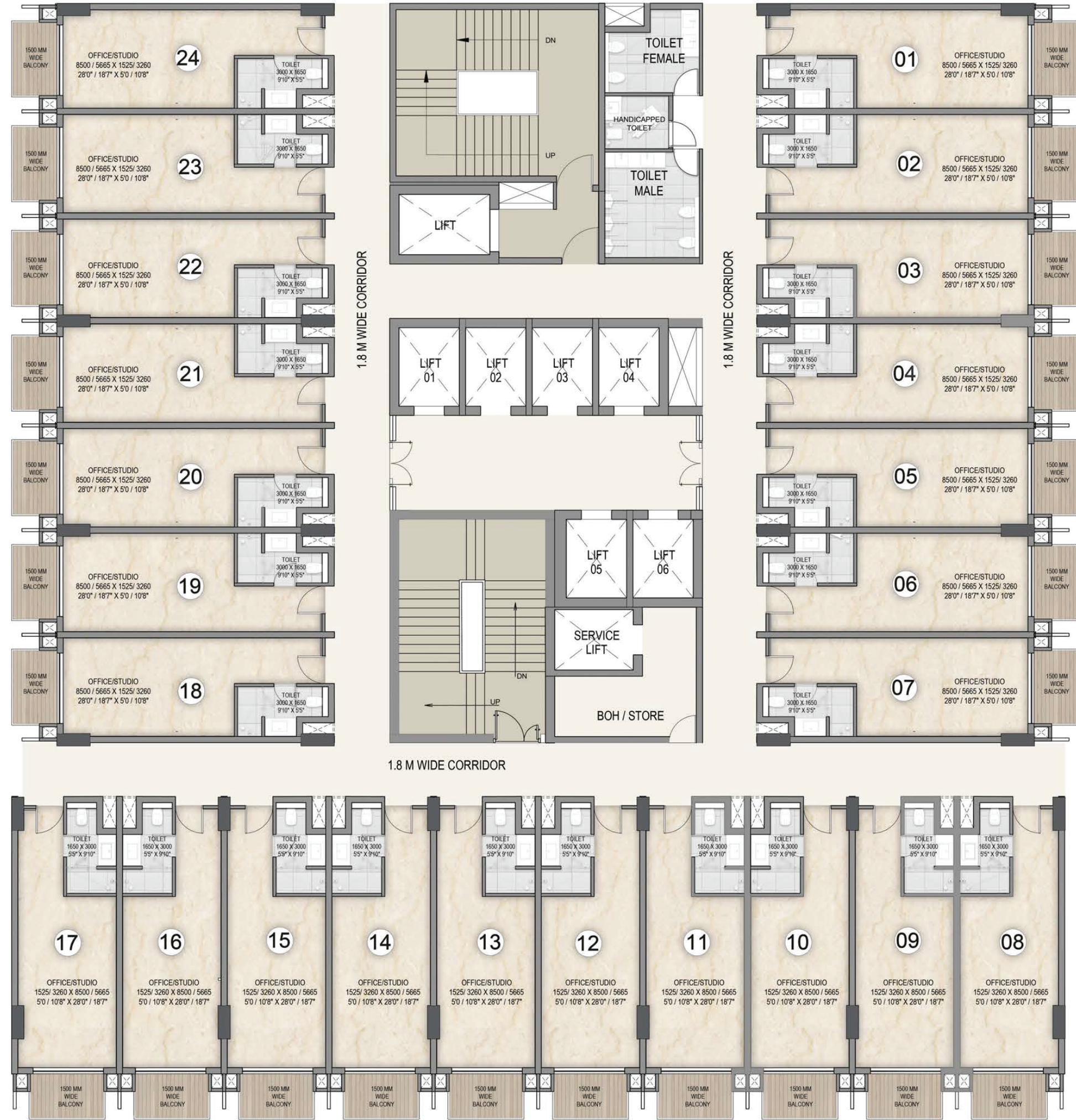

Typical Office - 9 Units

Layout Plan Office Floor

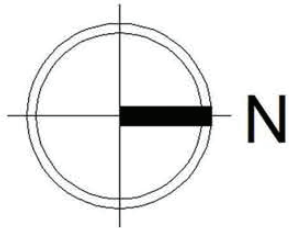
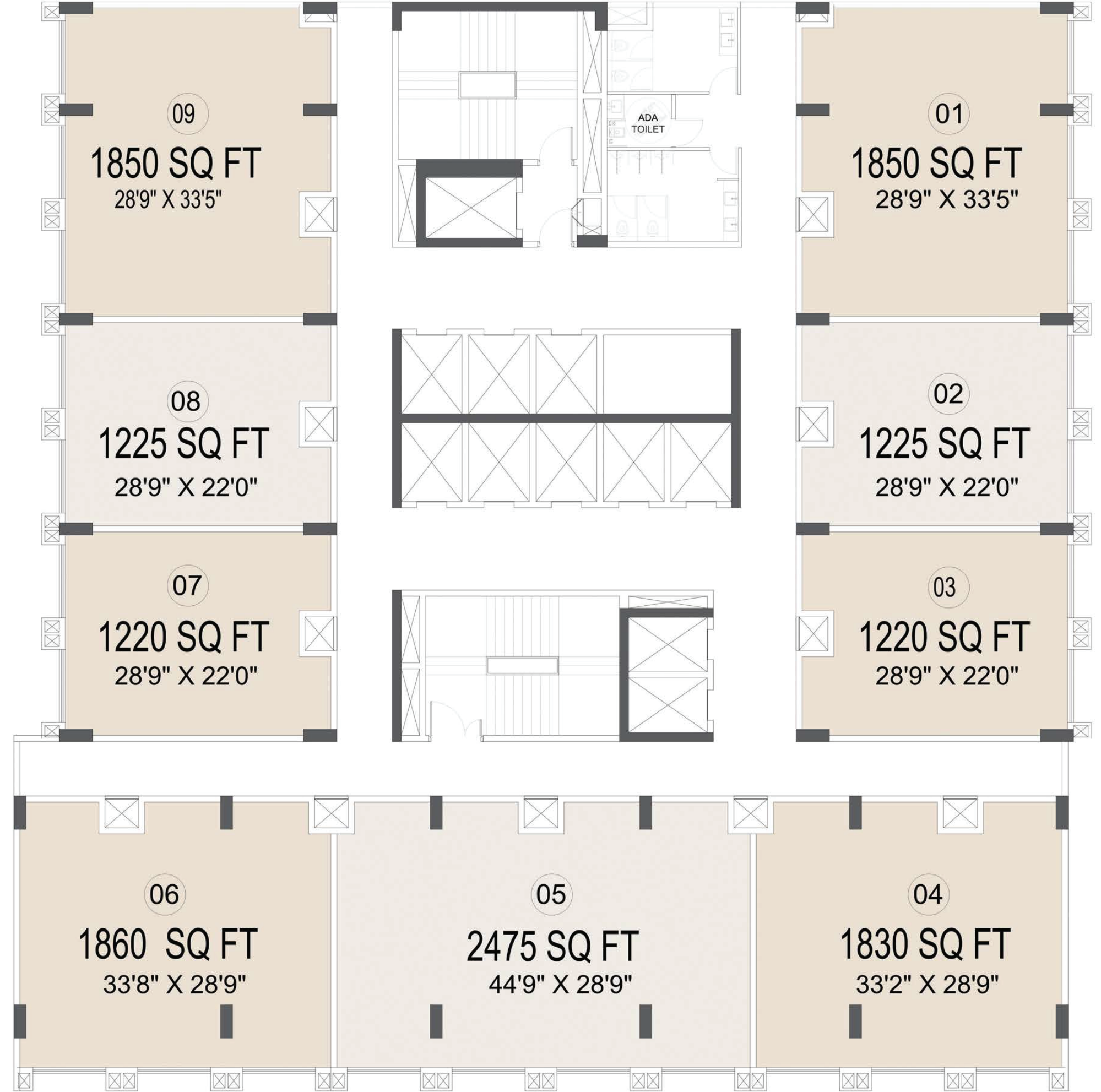

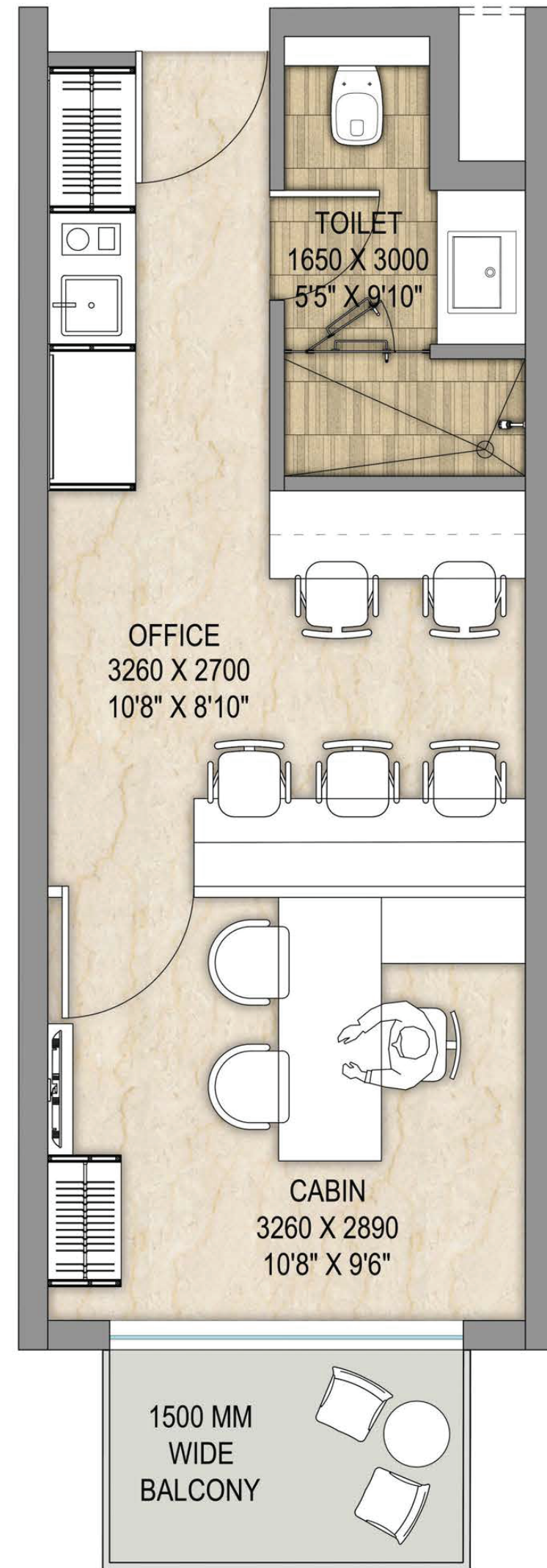

Work & Work Concept Layout
 Saleable Area - 686 Sq. ft.

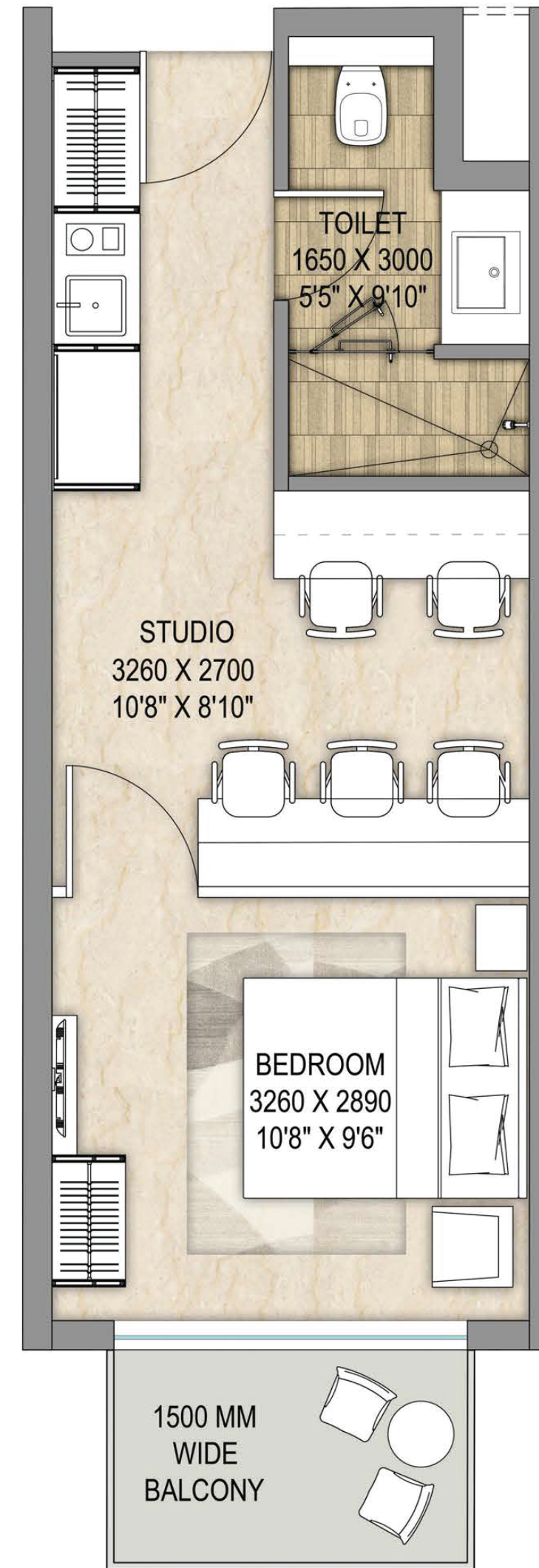

Live & Work Concept Layout
 Saleable Area - 686 Sq. ft.

Business Suites
Designed for business brilliance.

Main View of The Building



Email:- info@ganpaticapitalcourt.co | Web:- www.ganpaticapitalcourt.co



RUNNING PROJECTS

Ganpati Smart City

Ganpati Platinum Court

Ganpati Wonder City

Ganpati Upvana

Hyatt Place - Katra J&K

COMPLETED PROJECTS

Ganpati Magnum Square - Alwar

Ganpati World

Ganpati World II

Ganpati Dham

Ganpati Infinity

Ganpati Classique

Ganpati City

Ganpati Galaxy

Ganesh Plaza

Ganpati Ashiyana

Ganpati Apartment

Ganpati Tower

Ganpati Kings County

Ganpati Divine Homes

Sarovar Premiere - Alwar

UPCOMING PROJECT

Radisson Blu Hotel - Lucknow

Sarovar Premiere - Lucknow

Hyatt Hotel - Agra

Ganpati Manhattan - Agra



A Trend-setter Real Estate Player That Epitomizes

People, Partnerships and Performance

Constructed on the cornerstone of Competitiveness, Energy and Resilience, the Ganpati Group is a leading name in the real estate arena of India. Based out of the land of the Taj, Agra, Ganpati Group has spread its wings in varied sectors — from real estate to successful commercial developments. Over its years of triumphant existence, the group has delivered landmark projects that have made the Ganpati name synonymous with trust and integrity.

When pioneering minds come together, innovation happens. Under the helm of a robust leadership team, the group has traversed geographical boundaries and diversified into multiple sectors across India. With a future-focused mindset and a passion for excellence, Ganpati Group continues to raise benchmarks in construction and design.

While real estate remains the group's core strength, Ganpati Group has also made impactful strides into the hospitality and healthcare sectors — developing state-of-the-art hotels and medical infrastructure that cater to evolving lifestyles and community wellbeing. These ventures reflect the group's deep-rooted commitment to enriching lives and building holistic ecosystems.

From crafting dream homes to curating exceptional commercial spaces, Ganpati Group aims to make a lasting difference in every life it touches. Now poised for a bold new chapter, the group is driven by a vision to create infrastructure that is innovative, inclusive, and built to endure.

IN COLLABORATION WITH INDIA'S BEST

(CHIEF ARCHITECT)



(MEP CONSULTANT)

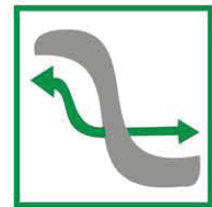

(RESIDENT ARCHITECT)



(STRUCTURAL CONSULTANT)



(LIGHTING CONSULTANT)



(LANDSCAPE CONSULTANT)



(GRAPHIC & BRANDING)



Disclaimer : The views shown in the pictures may vary over the period and do not guarantee the same. All intending purchasers (s) are bound to inspect all plans and approvals visit the project site and apprise themselves of all plans and approvals and other relevant information obtained from time to time from respective authorities. The promoter holds no responsibility for its accuracy and shall not be liable to any intending purchaser or anyone for the changes/ alterations/ improvements so made.

The visual representation shown in this brochure is purely conceptual and not a legal offering. All images, plans, specifications, site plans, layout plans, etc are tentative and subject to variation and modification by the company or the competent authorities sanctioning plans.